

FIRST FLOOR PLAN 14'11" x 10'

2ND FL. HOR. HFS 6'10"  
1ST FL. HOR. HFS 6'0"  
VERIFY RGS W/MANUFACTURER

MARK	MFG	TYPE	NUMBER	ROUGH OPENING	HZR	REMARKS	QTY
A	JENO WEN	DH	2370	32 1/2" X 72 1/2"	2-2410		2
B		DH	2371	67 1/2" X 72 1/2"	2-2410	W/12PLY	3
C		EMDR	9080	108 1/2" X 9 1/2"	2-1 3/4" X 1 1/2" LVL		1
D		EMDR	6080	70 1/2" X 9 1/2"	2-2410	W/12PLY	1
E		CASPART	1821-7	57 1/2" X 58 1/2"	2-2410	W/12PLY	1
F		DH	2370	32 1/2" X 72 1/2"	2-2410		1
G		FR DR	2081-10	67 1/2" X 9 1/2"	2-2410	W/12PLY	1
H		DH	2370	67 1/2" X 72 1/2"	2-2410		1
J		DH	2370	32 1/2" X 72 1/2"	2-2410		4
K		DH	2370	32 1/2" X 72 1/2"	2-2410		1
L		WREN EV	2660-10	60 1/2" X 60 1/2"	2-2410	W/12PLY	1
M		DH	2960	30 1/2" X 60 1/2"	2-2410		9
N		DH	2960	30 1/2" X 60 1/2"	2-2410		3
O		CASPART	2410-7	72 1/2" X 108 1/2"	2-2410	W/12PLY	1
P		DH	2370-7	102 1/2" X 60 1/2"	2-1 3/4" X 1 1/2" LVL		1

HEADERS 1 SPAN 13'0" 2-1 3/4" X 11 7/8" LVL  
2ND JOIST T=640 T=1464 X 1280 V  
L=480 L=988 X 960 V  
3RD JOIST T=640 T=1280  
L=480 V=960

- NOTES:**
- NEM PORTAL FRAME AT WALLS LESS THAN 2'-0"
  - HURRICANE CHIPS REQ'D
  - VENT ALL BATHS TO EXTERIOR
  - MIN. 1/2" PLY SHEATHING APPLIED TO 2x4 CHANGESTUDS @ 16" OC (VERTICAL) W/A MIN. 40WIDE PANEL @ EACH CORNER. 2x4 NAILS @ 6" OC FOR EYES AND 12" OC IN THE FIELD (TYPICAL NAILING PATTERN THROUGHOUT CONT. SHEATHED EXTERIOR) MAXIMUM HORIZONTAL DISTANCE BETWEEN PANELS = 24" OC
  - 3" OC NAILING PATTERN AT BOTH SIDES AND JACKS FOR ALL WINDOW AND DOOR OPENINGS.
  - WIND SPEED 100 MPH
  - SNOW DESIGN LOAD 40 PSF
  - EXPOSURE B LIVE LOADS 40 PSF 1ST FL  
30 PSF 2ND FL  
70 PSF ATTIC
  - THIS PLAN MEETS THE 8TH EDITION OF THE MASS STATE BUILDING CODE
  - RECOMMENDED FASTENERS TRUSLOCK ENGINEERED WOOD FASTENERS AND BOSSCH HURRICANE NAILS

1632 SF

**SHANE STRUCTURES**  
P.O. Box 81 - Hopkinton, MA 01748 - Phone/Fax: 888-522-7129

**THE BEECHWOOD HILLS**  
2 of 9

FIRST FLOOR PLAN 14'11" x 10'

DATE: DEC 2013 BY: SCOTT ROGERS

- ⊙ SMOKE DETECTOR
- ⊕ HEAT DETECTOR
- ⊗ CARBON MONOXIDE DETECTOR



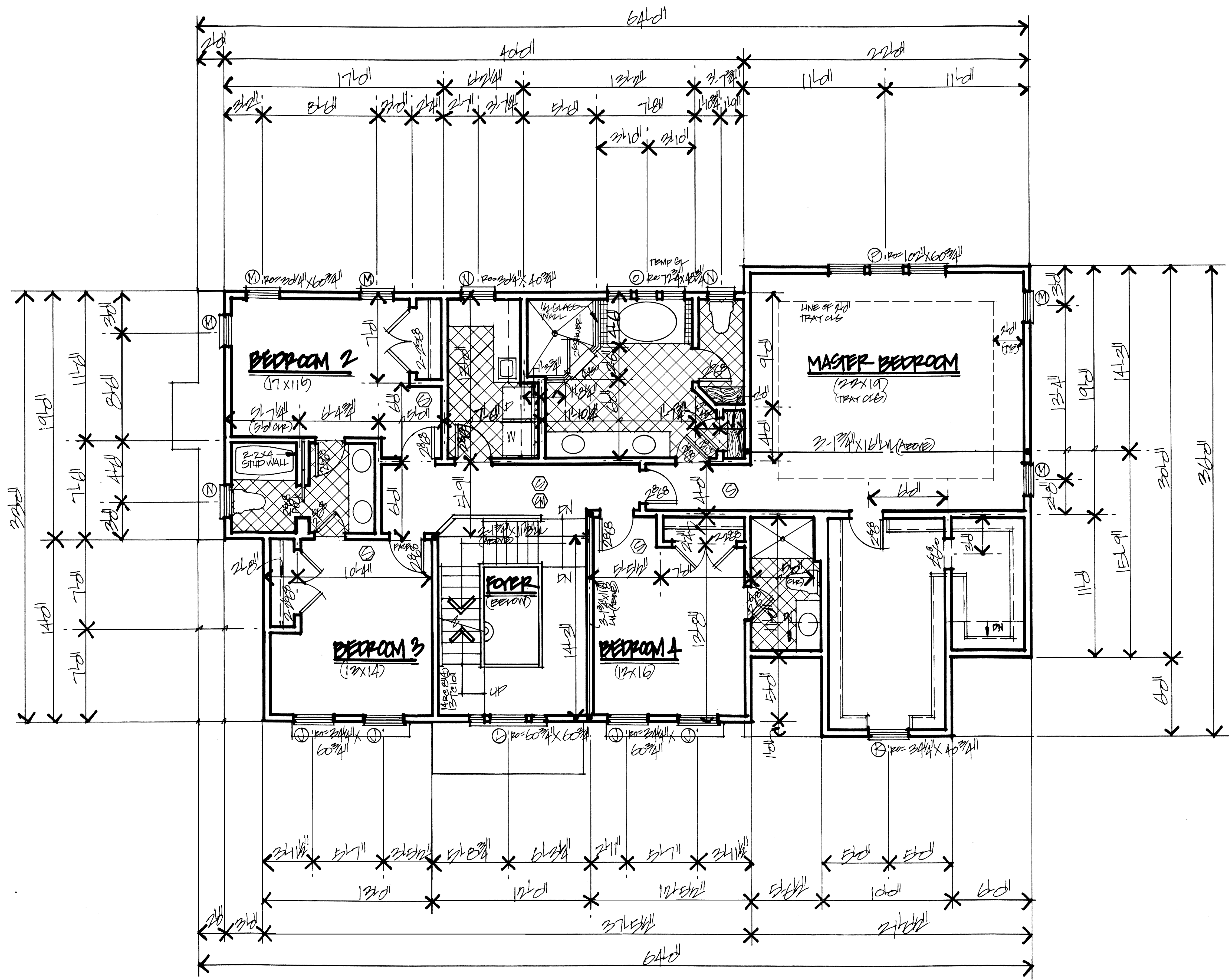

**SECOND FLOOR PLAN**  $\frac{1}{4}'' = 1'-0''$

1998

<b>SHANE STRUCTURES</b>	
<small>P.O. Box 81 · Hopkinton, MA, 01748 · Phone/Fax: 888-522-7129</small>	
<b>THE BEECHWOOD HILLS</b>	
<b>309</b>	
SECOND FLOOR PLAN	V.H.H.
DATE: DEC, 2013	BY: SCOT ROGERS

- ⊙ SMOKE DETECTOR
- ⊕ CARBON MONOXIDE DETECTOR